



Toyota genuine parts

Genuine parts provide real added value!

SAFETY
QUALITY
RELIABILITY





WHAT ARE TOYOTA GENUINE PARTS?

All Toyota genuine products are the result of extensive research and rigorous testing procedures. Every product undergoes detailed examination to guarantee it meets Toyota's exacting standards of high quality, reliability and performance. Only products that pass these strict assessments are passed to our customer, thereby helping to ensure your safety and the long life of your vehicle. In addition, all Toyota genuine products benefit from a trusted Toyota warranty to ensure that vehicles run optimally and offer the outstanding performance you expect. Toyota assumes no warranty whatsoever for any problems resulting from the use of parts other than Toyota genuine parts.

WHY BUY GENUINE PARTS?



1

High quality products which are certified and maintain your Toyota warranty.



2

100% guarantee that the parts are made to Toyota specifications and fit perfectly.



3

High resale value of your Toyota due to usage of only Toyota genuine parts.

WHERE TO BUY TOYOTA GENUINE PARTS?

CFAO, your only official Toyota distributor for Toyota genuine parts in your country.

Find all your original parts in CFAO dealerships. Purchasing maintenance, mechanical repair and bodywork parts from CFAO is the guarantee of having original manufacturer parts suitable for the vehicles and preserving the safety of the driver and passengers. CFAO network provides a large stock managed according to the needs of our customers.

CUSTOMER BENEFITS



At the resale:

A well-maintained vehicle within CFAO network with original parts and a maintenance book that meets the manufacturer's recommendations brings you real added value.



Peace of mind:

You are using genuine parts, you ride with peace of mind!



Financial advantage:

Using genuine parts allows you to save considerably on the maintenance of your vehicle, they are more durable over time and do not need frequent replacement unlike counterfeit parts.

Let's talk about your spare parts

Some Toyota parts families



WHAT IF WE TALK ABOUT COUNTERFEIT PARTS?

Counterfeit parts safety risks for consumers.

Counterfeit parts are not made from the same materials and are not subject to the same quality controls as genuine Toyota products. It leads to health risks for the driver and passengers. Non-genuine parts wear down faster and can cause car breakdowns or accidents.

Financial risk for consumers.

Counterfeit parts (spark plugs, wiper blades, brake linings, oil filters and cabin air filters) can damage the vehicle and lead to costly repairs. The use of counterfeit parts can result in the loss of cover provided by your vehicle's manufacturer warranty.

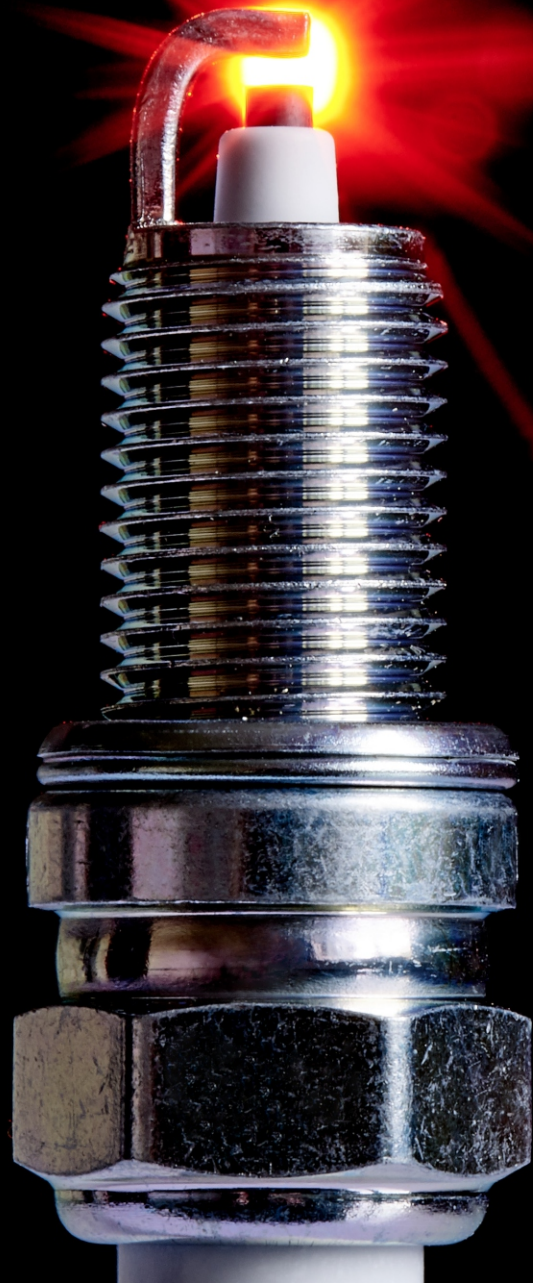

*WHAT IF WE
MADE SOME
SPARKS?*

Spark plug function:

Spark plugs play a major role in the engine's overall performance. When small amounts of fuel are injected into the engine, the spark provided by the spark plugs causes the fuel to explode. The energy from these explosions powers the car.

Genuine Toyota spark plugs:

Worn spark plugs will affect engine performance and reduce fuel consumption. Therefore, it is important that the spark plugs are replaced periodically.

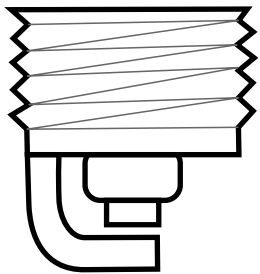

NICKEL ALLOY SPARK PLUG

Conventional type plug

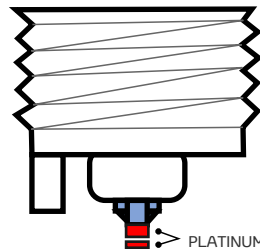

PLATINUM -TIPPED SPARK PLUG

Long-life plug

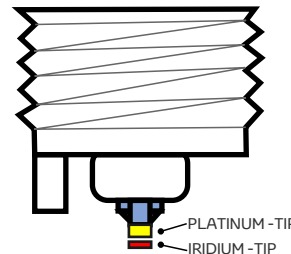

IRIDIUM TIPPED SPARK PLUG

Long-life plug that provides a strong spark

TYPE	MAINTENANCE INTERVAL
Nickel	Periodic Replacement (Every 10,000 km to 20,000 km)
Platinum	Every 100,000 km
Iridium	Every 100,000 km

AUTHENTIQUE CONTREFAITE

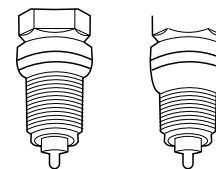

Advantages of original spark plugs:

Superior ignition performance:

Genuine Toyota spark plugs allow the engine to achieve superior cranking performance, acceleration and fuel consumption.

Protection for Other Electrical Components:

A strong electric current flows through the spark plugs, so they can affect other electrical components when using a counterfeit spark plug. Toyota genuine spark plugs have a built-in feature that prevents them from causing damage to other electrical components.



Beware of counterfeit!

They may look like the original parts, but they do not offer the same performance. There are different types of genuine Toyota spark plugs specifically designed to fit each Toyota model. Let us help you choose the right spark plugs for your Toyota.





**WHAT IF WE
FILTERED?**

Function of oil filters:

The role of the oil filter is to remove impurities such as carbon residue and metallic particles from the engine oil. If you continue to use an oil filter past the recommended replacement timing, the engine oil will become more viscous and the filter will become clogged. This will eventually cause engine problems.

Genuine Toyota oil filters:

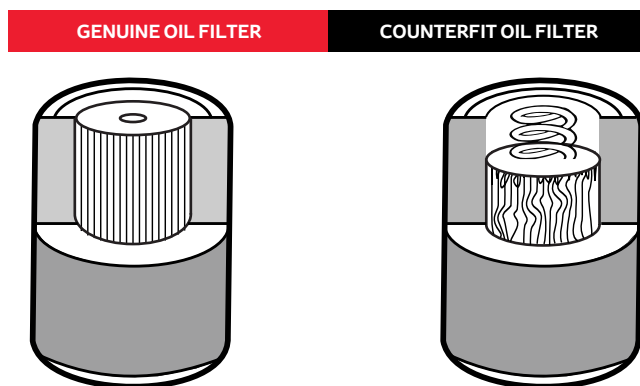

Cartridge Type
The whole filter requires replacing

Replaceable Element Type
Only the element needs replacing. Therefore, this type of filter contributes to preserving the environment by reducing the amount of metallic components that are used.

Recommended oil filter replacement:

If the oil filter is replaced regularly, the engine will run smoothly because the inside of the engine is kept lubricated with clean oil.

MAINTENANCE INTERVAL	
NORMAL CONDITIONS	SEVERE CONDITIONS
Approximately 10,000 km or 12 months	Approximately 5,000 km or 6 months

! Genuine Toyota oil filters advantages:

Superior filtration performance:

A genuine Toyota oil filter maintains superior performance over a long period of time.

Smooth engine oil circulation:

A genuine Toyota oil filter is a well-balanced product, capable of achieving high filtration performance while still ensuring the smooth flow of engine oil.



Beware of counterfeit!

They may look the same, but they don't offer the same filtration performance. A counterfeit oil filter contains low quality filter paper which is more likely to clog, which results in oil not being properly cleaned. Tests show that compared to genuine Toyota oil filters, counterfeit oil filters become clogged in half the time and need replacing more often.



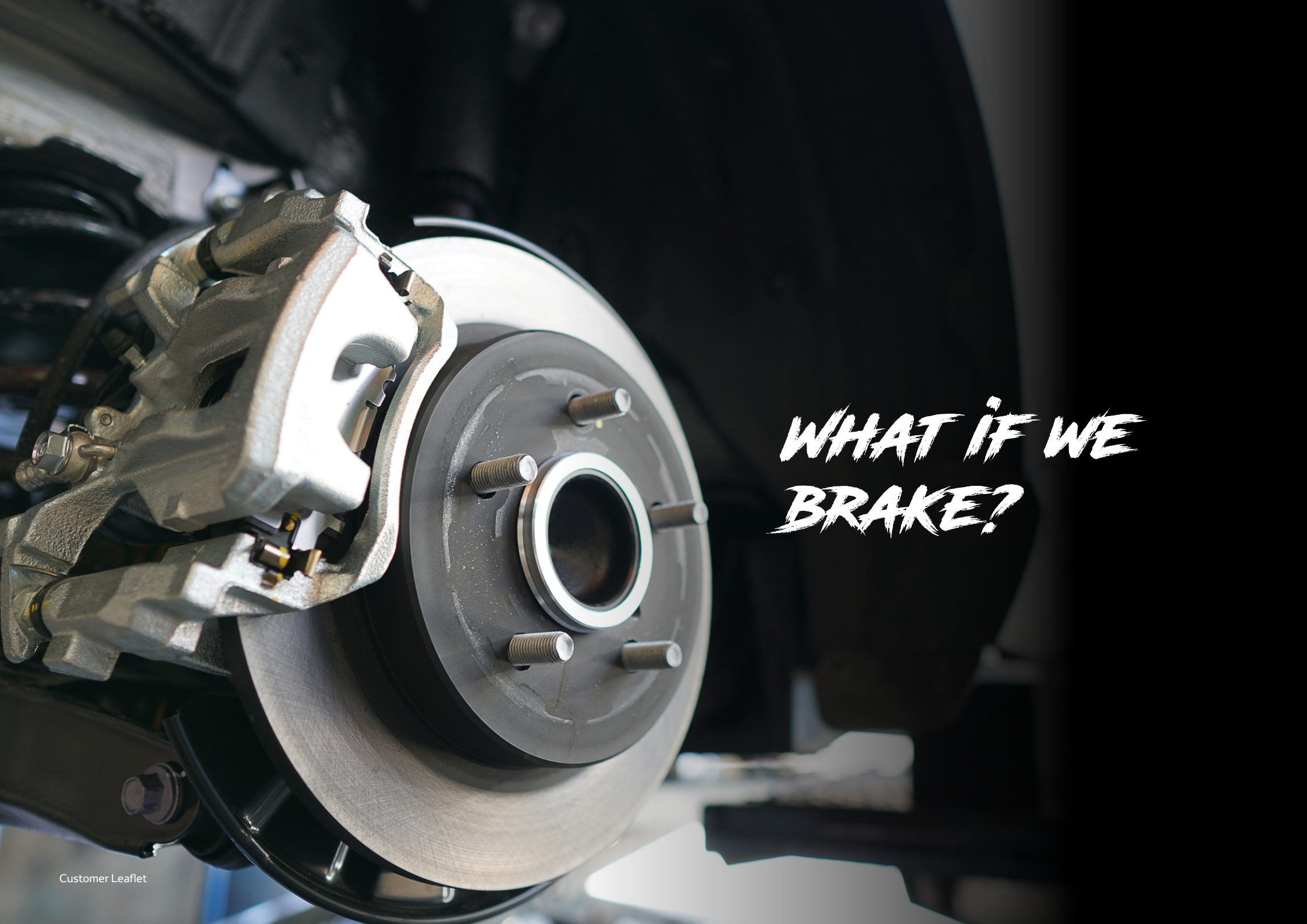

*WHAT IF WE
BRAKE?*

Function of brake pads:

Brake pads are composed of steel backing plates with a friction material. The friction material is pressed against the rotors, which rotate with the wheels and generate friction. This causes the vehicle to slow down or stop.

Genuine Toyota brake pads:

Brake pads are perhaps the most important parts affecting your vehicle's safety, which is why Toyota regularly conducts tests on them. Made from high quality friction material they are proven to perform to the highest standard. Our studies prove that the typical stopping distances with Toyota genuine brake pads are 30% shorter than those achieved with counterfeit version.

GENUINE TOYOTA BRAKE PAD

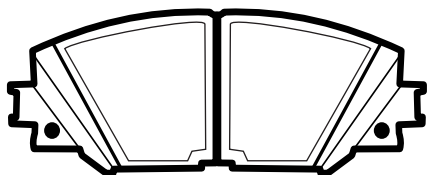

COUNTERFEIT TOYOTA BRAKE PAD

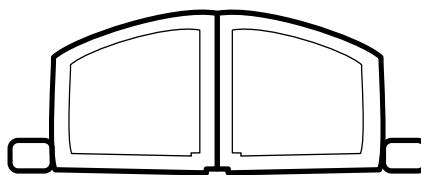

CATEGORY	EXPECTED LIFE	MAINTENANCE INTERVAL
Compact Vehicles	40,000 KM - 50,000KM	APPROXIMATELY 20,000 KM
Sports Car	20,000 KM - 30,000KM	
Rvs	20,000 KM - 30,000KM	



Benefits of genuine Toyota brake pads:

Safety and quality: All Toyota genuine brake pads are designed and tested to ensure maximum safety. At every stage of normal wear the braking performance is still at its maximum 100%. Superior performance like this demands high-grade materials, and that's what you get with Toyota genuine brake pads.

Made to match: Toyota genuine brake pads are designed to match each specific Toyota model. This ensures rapid replacement and no compatibility problems.



Beware of counterfeit!

They may look the same, but they don't offer the same braking performance. Counterfeit pads are generally made from visibly inferior materials which impart a braking force insufficient to reach basic performance levels. Other problems include premature wear, shorter life and the creation of grooves in the brake disc, which causes vibrations, rapid wear and frequent need for replacement.





Choose Toyota,

choose safety and quality.

**SAFETY
QUALITY
RELIABILITY**

